

Pressure Transmitter C02

for absolute or gauge pressure

- ceramic measuring element
- stainless steel housing
- standard G $\frac{3}{4}$ " thread
- nearly flush diaphragm
- rugged construction



Applications

hydraulic facilities, industrie and research
process engineering

Technical specifications

Pressure range, gauge		0..1bar bis 0..10bar, special ranges without extra charge					
Standard pressure range	bar	1	1,6	2,5	4	6	10
Overload	bar	3	3	5	8	10	15
Linearity	% FS	< 1					
Pressure hysteresis and repeability	% FS	< 0.3					
Thermal effect on zero	% FS/10K	0.3					
Thermal effect on span	% FS/10K	0.2					
Media temperature range	°C	-10..+85					
Operating temperature range	°C	-10..+85					
Storage temperature range	°C	-25..+85					
Excitation voltage		9-30VDC (with current output) 14-30VDC			allowable ripple @ 50Hz: 10%		
Output signal		4-20mA (2-wire-technique), 0-20mA (3-wire-technique), 0-10V					
Electrical connection		M12-connector cable-connector not included			reverse polarity and shortcircuit protection		
Pressure connection		G3/4"					
Protection class		IP67					
EMC		EN 50 081-1 EN 50 082-2					
Material pressue connection		V2A (1.4305)					
Material diaphragm		ceramic (Al ₂ O ₃)					



Pressure Transmitter

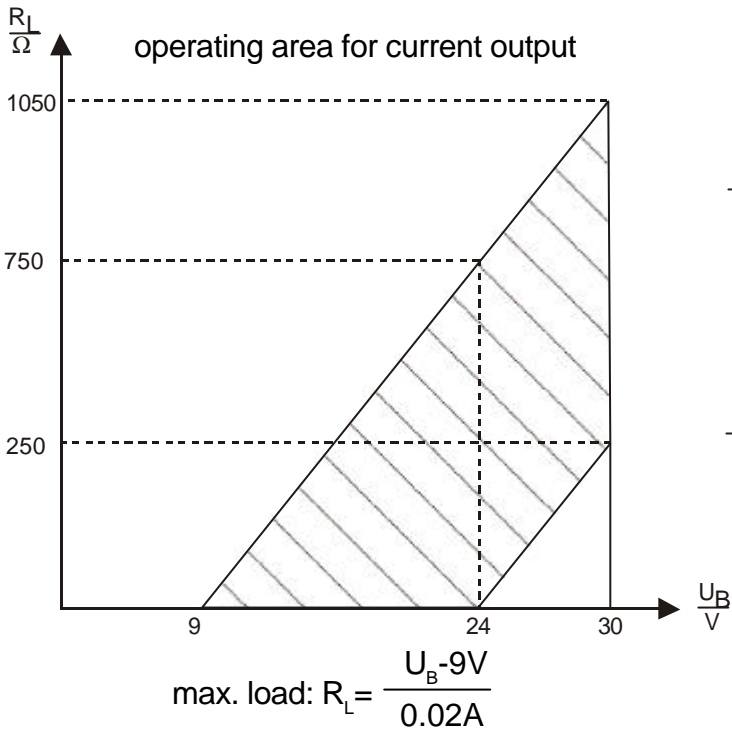

Electrical connection for 2-wire-technique

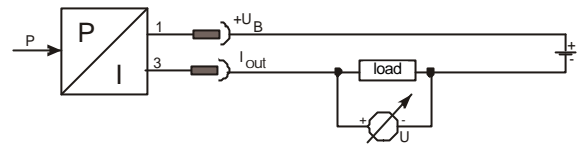

Electrical connection for 3-wire-technique

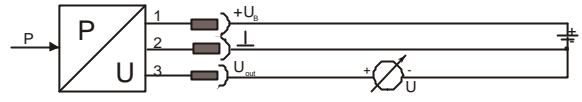

Pin occupancy M12-connector



Connection STW-Pressure transmitter

	plug pins	
	4-20mA	0-10V
+UB	1	1
GND	-	2
output	3	3

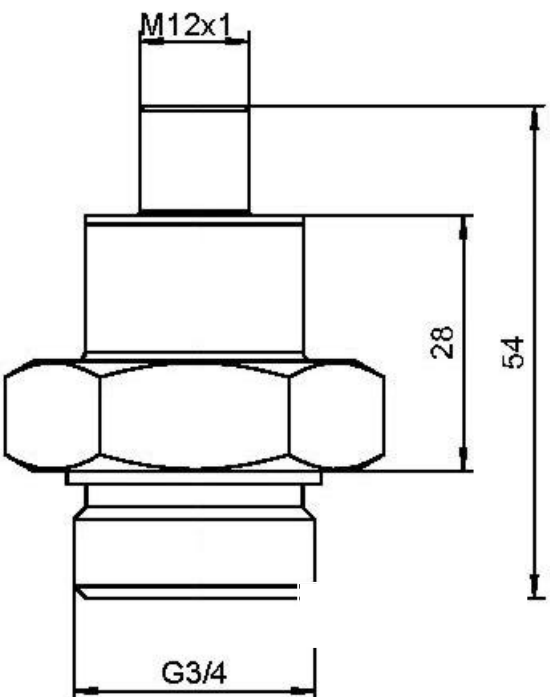

Order characterization:

Pressure transmitter type C02
 Pressure range: ...bar
 Output signal:

subject to change without notice
 MS 02/04

